

Parking

Other Information

Directions



Safe, convenient patient parking is available at several locations near the University of Maryland Medical Center.

1. The underground University Plaza Garage on W. Redwood Street, just opposite University of Maryland Medical Center and the University of Maryland Professional Building is reserved for patient parking. Be sure to take your parking ticket with you for validation. Many University Physicians practices offer free or discounted parking. Check with the staff at the office you visit for more information.

Other parking options include:

2. Valet parking services are available at the main entrance.
3. Medical Center Garage located across the street from the Gudelsky entrance is an underground garage available for patients and families.
4. Baltimore Grand Garage, Paca Street, between Baltimore and Fayette Streets
5. Marriott Hotel Parking, Lombard and Eutaw Streets
6. Allright Parking, W. Redwood and Eutaw Streets

7. Allright Parking, Lombard and Eutaw Streets
8. Redwood Garage, Eutaw and W. Redwood Streets
9. Penn Garage, Penn and Pratt Streets

Arriving and departing patients may be dropped off and picked up in the circular drive in front of the hospital. Parking is available in front of the hospital for 20 minute drop-off and pick-up only.

Valet parking service is available at the front entrance of the medical center. If you need assistance getting from building to building, the Medical Center offers a shuttle service. For assistance, dial the information desk at 410-328-5473 (or 8-5473 from any in-house phone).

Parking During Stadium Events Access to W. Redwood Street and the University Plaza Garage will remain reserved for patient and patient visitor parking during events at Oriole Park at Camden Yards.

Stadium traffic should be considered when traveling to Medical Center after 5 p.m. or on weekends.

ARRIVING BY MASS TRANSIT

Bus:
MTA buses 1, 2, 3, 5, 7, 8, 10, 11, 15, 20, 23, 28, 31, 35, 36, and 91 stop in the Medical Center area. (MTA provides lift-equipped buses for those who need wheelchairs or assistance with steps. Call 410-682-5438.)

Subway:

- Lexington Market Station, Eutaw and Lexington Streets (4 blocks)
- Charles Center Station, Baltimore at Charles Street (5 blocks)

Light Rail:
The Central Light Rail Line stops at the University Center/Baltimore Street Station three blocks from the Medical Center. For up-to-date information on fares and routes, visit www.mtmaryland.com.

SPECIAL ACCOMMODATIONS

The Hope Lodge,
636 W. Lexington St., offers home-like lodging at no cost for cancer patients and their companions. The Hope Lodge is a project of the American Cancer Society. 410-547-2522

The Ronald McDonald House,
635 W. Lexington St., offers a home away-from-home for families of children with a range of lifethreatening diseases. 410-528-1010
www.rmhbaltimore.com

The Medical Center Chaplain's Office is available to assist patients and families needing low cost accommodations. 410-328-6014

HOTEL INFORMATION

If you need to stay overnight during your visit to UMMC, a number of hotels are convenient to the Medical Center. When requesting a reservation, request the special discounts offered to Medical Center patients and their families.

Hotels:
(for lodging prices, please call the hotel)

Baltimore Marriott Inner Harbor at Camden Yard
Eutaw and Pratt Streets
410-962-0202

Days Inn Inner Harbor
100 Hopkins Place
410-576-1000

Hampton Inn Baltimore/Camden Yards
131 E. Redwood St.
410-539-7888

SpringHill Suites by Marriott Inner Harbor
120 E. Redwood St.
410-685-1095

For Longer Term Stays:
Bridgestreet Corporate Housing Worldwid
888-266-0900

Charles Towers
222 N. Charles Street
410-625-5700

Marlboro Square
410 W. Lombard Street
410-659-6600

Oakwood Apartments at the Park Charles
300 W. Lombard Street
410-752-4950

IF YOU NEED MORE INFORMATION

If you have questions or concerns about your visit to the Medical Center, we are happy to provide you with answers or more information. Please call us at 1-800-492-5538 or log on to www.umm.edu.

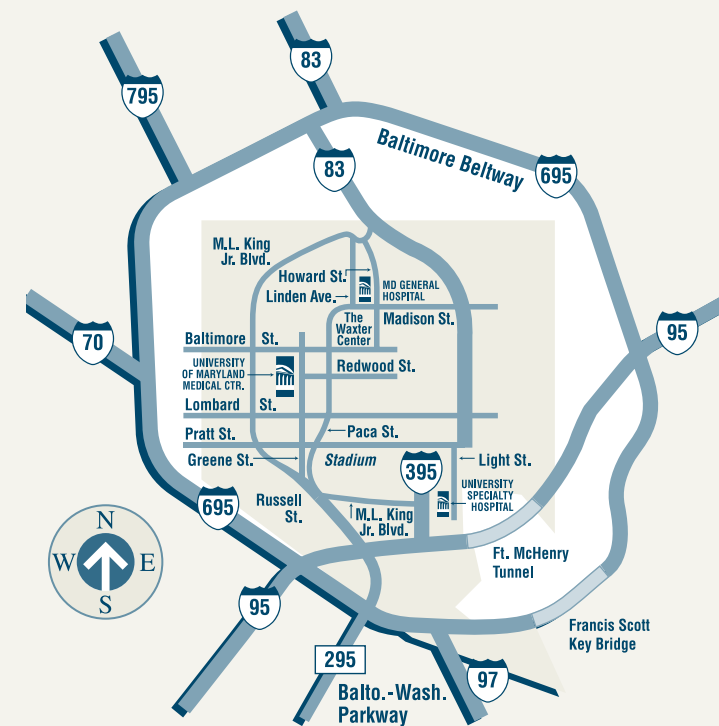

From the North or South:

Follow I-95 to the Russell Street Exit. Follow Russell Street as it merges into Paca Street. Go two blocks on Paca; turn left onto Redwood Street. Enter the underground University Plaza Garage on your right.

From I-83:

Follow I-83 (Jones Falls Expressway) to the end. Go two traffic lights and turn right onto Lombard Street. Follow Lombard for 12 traffic lights and turn right onto Paca Street. Turn left at the next light onto Redwood Street. Enter the underground University Plaza Garage on your right.

From the West:

Take I-70 east to I-695 South (Glen Burnie). Follow I-695 to I-95 North. Take the Russell Street Exit. Follow Russell Street as it merges into Paca Street. Go two blocks on Paca; turn left onto Redwood Street. Enter the underground University Plaza Garage on your right.

From Washington D.C. or BWI Airport:

Follow I-295 North to Baltimore. Inside the city I-295 becomes Russell Street. Follow Russell Street as it merges into Paca Street. Go two blocks on Paca; turn left onto Redwood Street. Enter the underground University Plaza Garage on your right.

Guide & Locator Maps



Campus Map

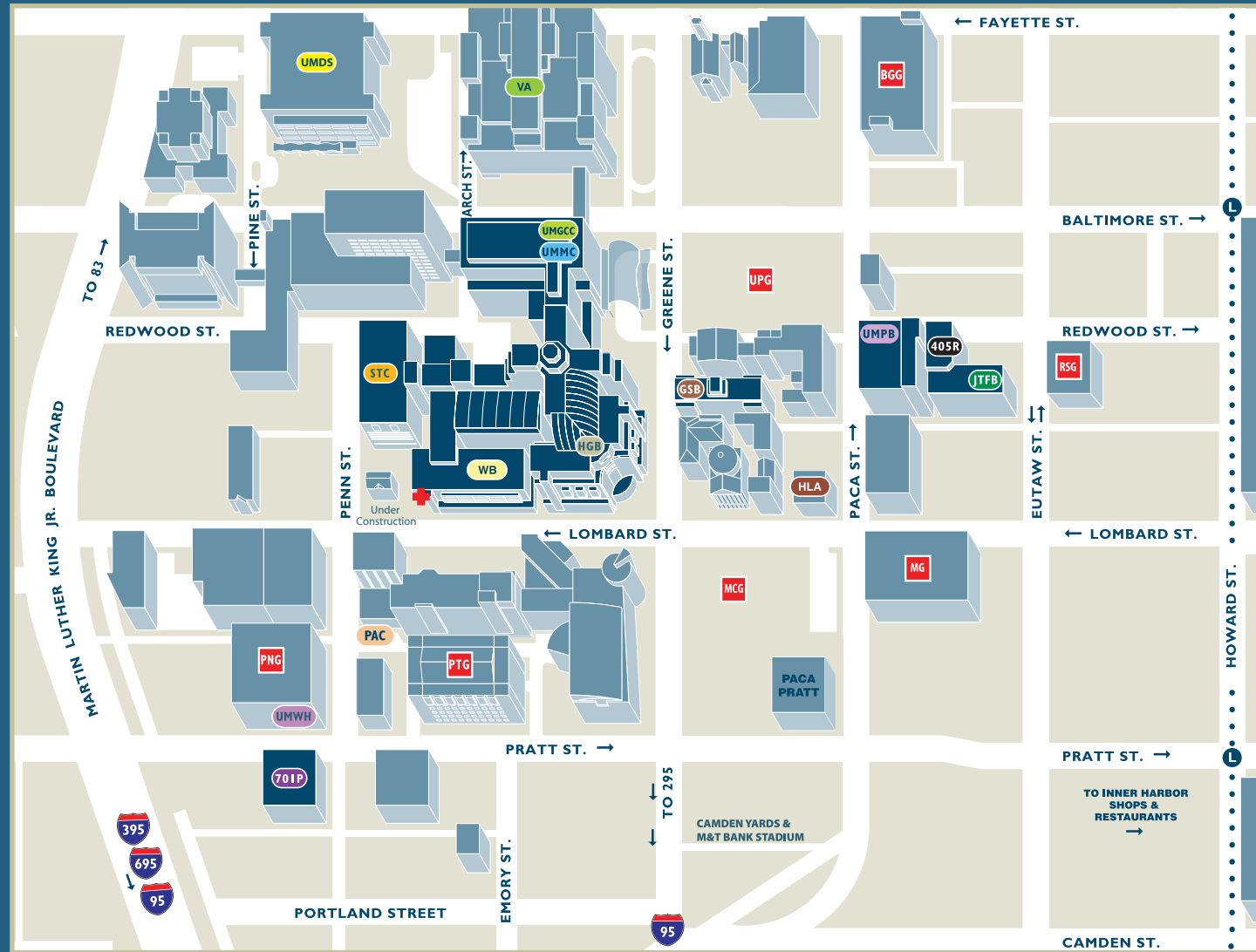

- | | |
|--|------------------------------------|
| Patient Care Buildings | Parking |
| 405R 405 West Redwood St. Building | BGG Baltimore Grand Garage |
| 701P 701 West Pratt St. Building
Behavior Health Services | MG Marriott Garage |
| GSB The Harry & Jeanette Weinberg Office Building
29 S. Greene Street
Institute of Transplantation | MCG Medical Center Garage |
| HGB Homer Gudelsky Building | PNG Penn Garage |
| JTFB James T. Frenkil Building
16 South Eutaw Street | PTG Pratt Street Garage |
| WB The Harry & Jeanette Weinberg Building | RSG Redwood Street Garage |
| STC R. Adams Cowley Shock Trauma Center
Lombard & Penn | UPG University Plaza Garage |
| PAC Pediatric Ambulatory Center
105 S. Penn Street | |
| UMDs University of Maryland Dental School | |
| UMGCC Roslyn & Leonard Stoler Pavilion.
UM Marlene & Stewart Greenebaum Cancer Center
22 S. Greene Street | |
| UMMC University of Maryland Medical Center
22 S. Greene Street
Main Hospital Entrance | |
| UMPB University of Maryland Professional Building
419 West Redwood Street
Physician Offices | |
| MWH UM Women's Health
120 Penn Street | |
| VA VA Medical Center | |
| ER Emergency Room | |
| HLA Harbor Loft Apartments | |

- Light Rail**
- Light Rail Stop

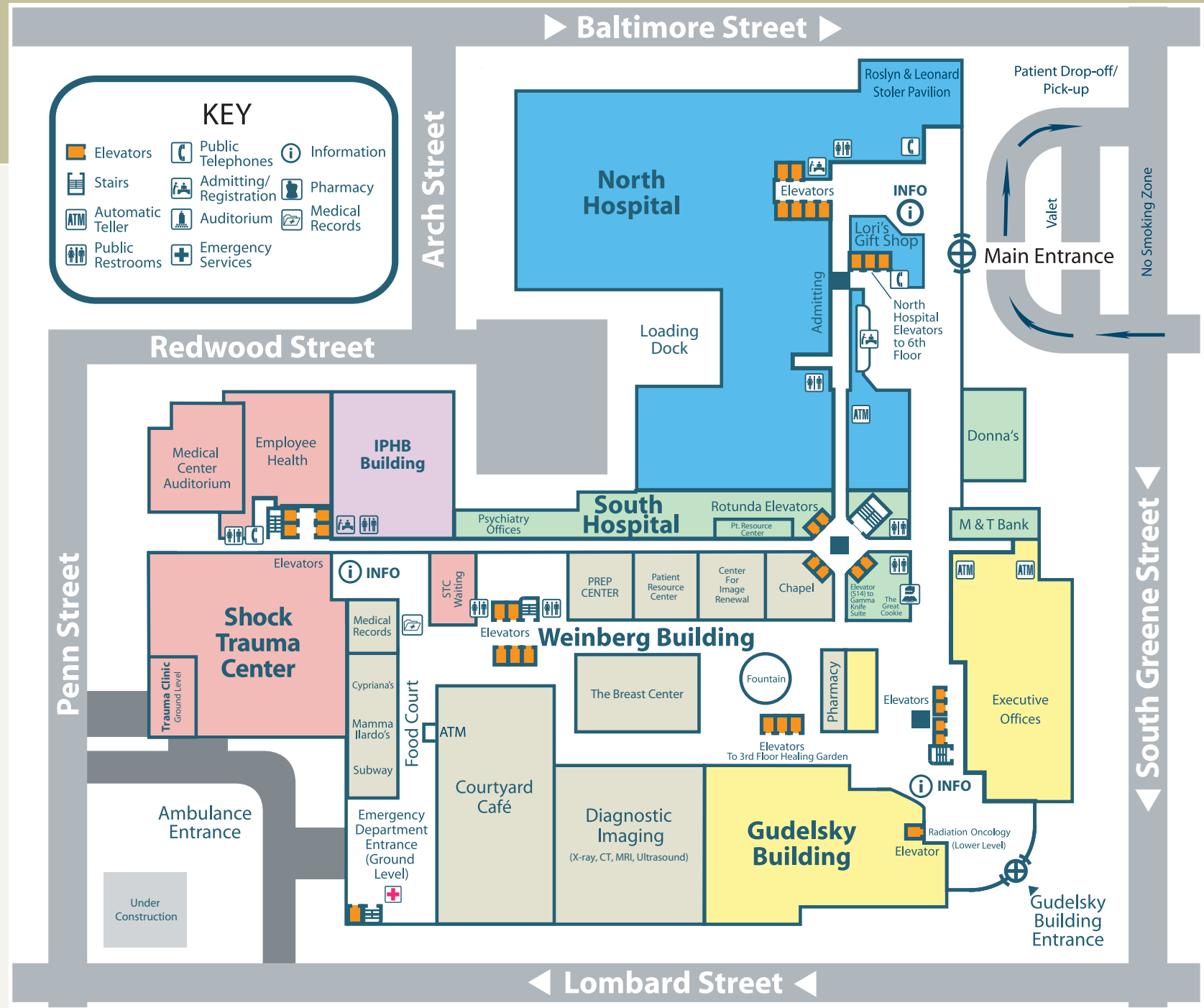

PATIENT LOCATIONS OUTSIDE THE MEDICAL CENTER INCLUDE:

- | | | |
|---|--|--|
| <p>Frenkil Building
16 S. Eutaw Street
(Patients should park at the University Plaza Garage)</p> <ul style="list-style-type: none"> 1 Evelyn Jordan Center 2 UHC (University Health Center) Transplant Clinic 3 Neurology Parkinson's and Movement Disorders Stroke Clinic 4 Otorhinolaryngology (Ear, Nose & Throat) 5 Physical Therapy | <p>The Harry & Jeanette Weinberg Office Building
29 S. Greene Street
Transplantation Clinic</p> <p>Pratt Street Building
701 Pratt Street
(Patients should park at the Penn Garage)</p> <p>Child Psychiatry
Community Support Program (CSP/SSI)
Geriatric Adult Day Hospital
Maryland Center for Attention and Developmental Disorders
Psychiatric Outpatient
Psychiatric Residency Training Office</p> <p>29 S. Paca Street Building
Family Medicine</p> | <p>Professional Building
419 West Redwood St.
(Patients should park at the Grand or Redwood Underground Garage)</p> <p>Dermatology
Emphysema Treatment Program
Employee Assistance Program
Maryland Prostate Center
Pathology Associates (Lab)
Pharmacy
Physician / Specialty Offices
Maryland Center for Eye Care
Maryland's Women's Center
Neurosurgery
Radiation Oncology
Tinnitus & Hyperacusis Center
University Imaging Center
University of Maryland Medical Group (Internal Medicine and Specialty)</p> |
|---|--|--|